



★ ★ ★ ★ ★ ★ **HELLO KITTY** ★ ★ ★ ★ ★ ★
©1976, 2013 SANRIO CO., LTD.

BLUETOOTH WIRELESS SPEAKER SYSTEM



USER MANUAL

KT4557MBY



**PLEASE READ THIS OPERATING MANUAL COMPLETELY
BEFORE OPERATING THIS UNIT AND RETAIN THIS
BOOKLET FOR FUTURE REFERENCE.**

IMPORTANT SAFETY INSTRUCTIONS

When used in the directed manner, this unit has been designed and manufactured to ensure your personal safety. However, improper use can result in potential electrical shock or fire hazards. Please read all safety and operating instructions carefully before installation and use, and keep these instructions handy for future reference. Take special note of all warnings listed in these instructions and on the unit.

1. The apparatus and AC adapter shall not be exposed to dripping and splashing and that no objects filled with liquids, such as vases, shall be placed on the apparatus and AC adapter.
2. The plug of the AC adapter is used as the disconnect device. The AC adapter should always remain readily accessible and should not be obstructed.
3. To completely disconnect the apparatus, unplug the adapter from the power outlet.
4. Minimum distance of 4 inches (10cm) around the apparatus and AC adapter should be made available for sufficient ventilation.
5. The ventilation should not be impeded by covering the ventilation openings with items such as newspapers, table clothes, curtains, etc.
6. No open flame sources such as lighted candles should be placed on the apparatus.
7. The apparatus and AC adapter should be used in moderate climates.
8. Do not attempt to dismantle, open or repair this product yourself. If a fault occurs, seek advice from your local qualified service technician or contact the distributor via the telephone number at the back of this instruction manual.
9. The rating plate of the apparatus is located on the rear of the unit.

IMPORTANT NOTES

Avoid installing unit in locations described below:

- Places exposed to direct sunlight or close to heat radiating appliances such as electric heaters.
- Places subject to constant vibrations.
- Dusty, humid or moist places.

COMPLIANCE WITH FCC REGULATIONS

This device complies with Part 15 of the FCC Rules. Operation is subject to the following two conditions:

- (1) this device may not cause harmful interference, and
- (2) this device must accept any interference received, including interference that may cause undesired operation.

NOTE: This equipment has been tested and found to comply with the limits for a Class B digital device, pursuant to Part 15 of the FCC Rules. These limits are designed to provide reasonable protection against harmful interference in a residential installation. This equipment generates, uses and can radiate radio frequency energy and, if not installed and used in accordance with the instructions, may cause harmful interference to radio communications. However, there is no guarantee that interference will not occur in a particular installation. If this equipment does cause harmful interference to radio or television reception, which can be determined by turning the equipment off and on, the user is encouraged to try to correct the interference by one or more of the following measures:

- Reorient or relocate the receiving antenna.
- Increase the separation between the equipment and receiver.
- Connect the equipment into an outlet on a circuit different from that to which the receiver is connected.
- Consult the dealer or an experienced radio/TV technician for help.

CAUTION: Changes or modifications not expressly approved by the party responsible for compliance could void the user's authority to operate the equipment.

PROTECT YOUR FURNITURE !

This model is equipped with non-skid rubber 'feet' to prevent the product from moving when you operate the controls. These 'feet' are made from non-migrating rubber material specially formulated to avoid leaving any marks or stains on your furniture. However certain types of oil based furniture polishes, wood preservatives, or cleaning sprays may cause the rubber 'feet' to soften, and leave marks or a rubber residue on the furniture. To prevent any damage to your furniture we strongly recommend that you purchase small self-adhesive felt pads, available at hardware stores and home improvement centers everywhere, and apply these pads to the bottom of the rubber 'feet' before you place the product on fine wooden furniture.

ACCESSORIES INCLUDED

Carefully remove the unit and all accessories from the gift box. Please verify that you have all the following accessories before you recycle the gift box

- BLUETOOTH SPEAKER UNIT
- AC ADAPTER
- AUX-IN CABLE
- USER MANUAL

LOCATION OF CONTROLS

FRONT

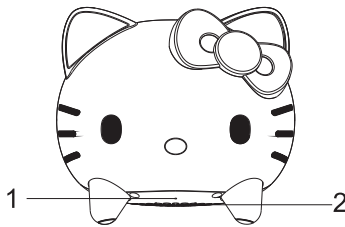

REAR

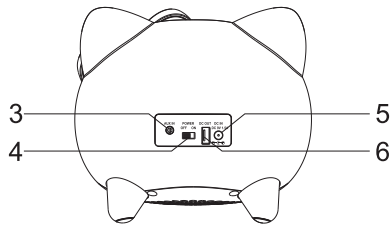

1	Power/Status Indicator	4	Power On/Off Switch
2	Full Range Speaker	5	DC Input Jack (DC9V 1.5A)
3	AUX IN Jack	6	USB Charging Port (DC5V 1A)

PLAYING MUSIC FROM A BLUETOOTH ENABLED DEVICE

1. Make sure the **Power On/Off Switch** is in OFF position. Insert the DC plug of the AC adapter (Included) into the **DC Input Jack** at the back of the unit.

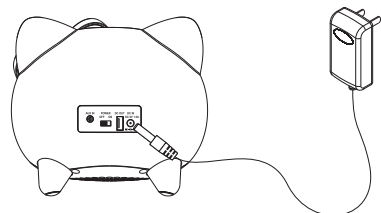
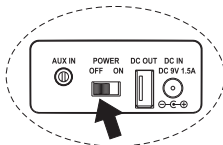

2. Connect the AC adapter to an AC 120V~ 60Hz power source. Use the **Power On/Off Switch** to turn the unit ON or OFF.

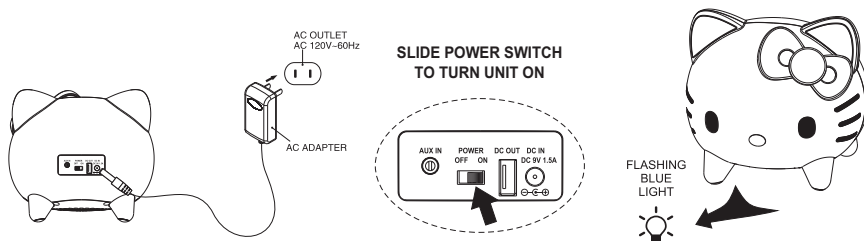

3. Turn on the unit by sliding the **Power On/Off Switch** to "ON". A short melody will be heard. The **Power/Status Indicator** should light and flash in blue.
4. If the unit has never been paired/linked with a Bluetooth enabled device before, you need to follow the pairing instructions below:
 - a) Turn on the Bluetooth function of your device and enable the search or scan function to find the unit.
 - b) Select "KT4557A" from the device list when it appears on your screen. Auto pairing between the unit and your Bluetooth enabled device will proceed.

NOTE: If you are pairing (linking) the unit to your Bluetooth enabled computer, you may need to set the KT4557A as the default sound device.
5. After turning on, the unit will search for the last paired device.
6. On successful pairing with your Bluetooth enabled device, you can play music on your device wirelessly from the speaker.
7. Adjust the volume on your Bluetooth enabled device to obtain the desired sound level.

NOTE: All control functions should be achieved from your Bluetooth enabled device.
8. If the unit needs to pair with another Bluetooth device, you need to turn off the Bluetooth function of the first device and then repeat step 4 above.
9. To turn the unit off, slide the **Power On/Off Switch** at the back to the OFF position. The **Power/Status Indicator** will go off.

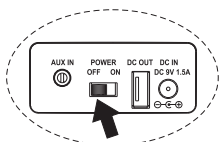

AUX INPUT OPERATION

The unit provides an auxiliary audio signal input jack for connecting external audio devices like MP3 players, CD players or an iPod (except iPod shuffle 3rd generation) and listen to them through the unit speaker.

1. Turn on the unit by sliding the **Power On/Off Switch** to "ON".
2. Plug one end of the included audio cable into the **AUX IN** jack at back of the unit and the other end into the headphone jack of your external audio device. The flashing blue light of the unit will become steady.

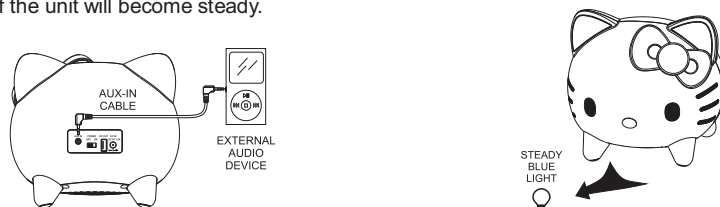

3. Turn on the external audio device.
4. Adjust the volume control of the external device to obtain the desired sound level.

Notes:

- We recommend connecting the headphone jack of your external audio device to the **AUX IN** jack on this unit. Then use the volume control on the connected device to adjust the overall sound level.
- If you connect the line out jack of your external audio device to this unit instead, the audio level can be very high and most probably you cannot adjust the volume level.
- When using the **AUX IN** function, the Bluetooth pair (link) will be temporarily disconnected until the audio cable is unplugged.
- Turn the unit off when you have finished listening. Don't forget to switch off the power of your external audio device as well.

CHARGING YOUR PORTABLE DEVICE

This unit features a USB port for charging your portable device (iPod, iPhone, Android enabled device, etc.) when used with the USB charging cord that came with it.

1. Turn on the unit by sliding the **Power On/Off Switch** to "ON".
2. Plug one end of the USB cable (not included) into the **USB Charging Port** located at the back of the unit. Plug the other end of the cord into the device you wish to charge.
3. Observe the battery charge indicator on your device to make sure the charging process starts and proceeds normally.
4. Unplug the USB cable when your device is fully charged.

CAUTION:

Before charging, please refer to the user manual of the device you wish to charge to make sure the charging current requested does not exceed 1A (1000mA). Overloading the charging circuit may cause permanent damage to the unit and void the warranty.

Notes:

1. There will be no charging function when the unit is turned "OFF".
2. Some smartphones and portable devices use proprietary USB connections, and circuitry, and may not charge when plugged into the USB port. This includes older iPod models including the iPod classic. Please refer to your device user manual before you attempt to charge them.
3. Due to increased power demand, it is normal for the unit to get warm while charging your smartphone or portable device.
4. Do not charge your smartphone or other portable devices for over 12 hours continuously. Disconnect your smartphone or other portable device from the USB cord once it is fully charged.

CARE AND MAINTENANCE

1. Avoid operating your unit under direct sunlight or in hot, humid or dusty places.
2. Keep your unit away from heating appliances and sources of electrical noise such as fluorescent lamps or motors.
3. In case of malfunction, unplug the unit from the electrical power outlet immediately.

CLEANING THE UNIT

- To prevent fire or shock hazard, disconnect the AC adapter of your unit from the AC power source when cleaning.
- The unit cabinet may be cleaned with a dust cloth and cared for as other furniture. Use caution when cleaning and wiping the plastic parts.

- If the cabinet becomes dusty, wipe it with a soft dry dust cloth. Do not use any wax or polish sprays on the cabinet.
- If the front panel becomes dirty or smudged with fingerprints, it may be cleaned with a soft cloth slightly dampened with a mild soap and water solution. Never use abrasive cloths or polishes as these will damage the finish of your unit permanently.

CAUTION: Never allow any water or other liquids to get inside the unit while cleaning.

90 DAY LIMITED WARRANTY AND SERVICE VALID IN THE U.S.A. ONLY

SPECTRA MERCHANDISING INTERNATIONAL, INC. warrants this unit to be free from defective materials or factory workmanship for a period of 90 days from the date of original customer purchase and provided the product is utilized within the U.S.A. This warranty is not assignable or transferable. Our obligation under this warranty is the repair or replacement of the defective unit or any part thereof, except batteries, when it is returned to the SPECTRA Service Department, accompanied by proof of the date of original consumer purchase, such as a duplicate copy of a sales receipt.

You must pay all shipping charges required to ship the product to SPECTRA for warranty service. If the product is repaired or replaced under warranty, the return charges will be at SPECTRA's expense. There are no other express warranties other than those stated herein.

This warranty is valid only in accordance with the conditions set forth below:

1. The warranty applies to the SPECTRA product only while:
 - a. It remains in the possession of the original purchaser and proof of purchase is demonstrated.
 - b. It has not been subjected to accident, misuse, abuse, improper service, usage outside the descriptions and warnings covered within the user manual or non-SPECTRA approved modifications.
 - c. Claims are made within the warranty period.
2. This warranty does not cover damage or equipment failure caused by electrical wiring not in compliance with electrical codes or SPECTRA user manual specifications, or failure to provide reasonable care and necessary maintenance as outlined in the user manual.
3. Warranty of all SPECTRA products applies to residential use only and is void when products are used in a nonresidential environment or installed outside the United States.

This warranty gives you specific legal rights, and you may also have other rights which vary from state to state. TO OBTAIN SERVICE please remove all batteries (if any) and pack the unit carefully and send it freight prepaid to SPECTRA at the address shown below. IF THE UNIT IS RETURNED WITHIN THE WARRANTY PERIOD shown above, please include a proof of purchase (dated cash register receipt) so that we may establish your eligibility for warranty service and repair of the unit without cost. Also include a note with a description explaining how the unit is defective. A customer service representative may need to contact you regarding the status of your repair, so please include your name, address, phone number and email address to expedite the process.

IF THE UNIT IS OUTSIDE THE WARRANTY PERIOD, please include a check for **\$25.00** to cover the cost of repair, handling and return postage. All out of warranty returns must be sent prepaid.

It is recommended that you contact SPECTRA first at 1-800-777-5331 or by email at custserv@spectraintl.com for updated information on the unit requiring service. In some cases the model you have may be discontinued, and SPECTRA reserves the right to offer alternative options for repair or replacement.

SPECTRA MERCHANDISING INTERNATIONAL, INC.
4230 North Normandy Avenue,
Chicago, IL 60634, USA.
1-800-777-5331

To register your product, visit the link below to enter your information.

<http://www.spectraintl.com/wform.htm>

Bluetooth is a registered trademark of Bluetooth SIG, Inc.

iPod and iPhone are registered trademarks of Apple Inc., registered in the U.S. and other countries

Android is a trademark of Google, Inc.

Licensed by:

Marino Andriani, LLC

Distributed by:

Spectra Merchandising International, Inc.

Chicago, IL 60634, USA

www.spectraintl.com

0713



HELLO KITTY®

by **Sanrio®**

©1976, 2013 SANRIO CO., LTD.

Used Under License.

www.sanrio.com



SIL-34037

Printed in China